

**LEGEND:**

1. PRESSED STEEL ACOUSTIC FRAME.
2. ACOUSTIC PERIMETER SEAL TO BE FITTED AND FASTENED TO JAMBS, MULLION, AND HEAD BY INSTALLER ON SITE.
3. ACOUSTIC NEOPRENE AT HEADER ONLY.
4. SECONDARY PERIMETER ACOUSTIC SEAL FOR STC 39 THROUGH STC 52 TO BE FITTED AND FASTENED TO JAMBS AND HEAD BY INSTALLER ON SITE.
5. ¼" HIGH FLAT ACOUSTIC THRESHOLD 5" WIDTH, TO BE INSTALLED ON FINISHED FLOOR.

STOCK ACOUSTIC FRAMES FOR PAIRED OPENINGS. AVAILABLE IN STC-33 THROUGH STC 51. STOCK FRAME SIZE IS 6'-0"x7'-0" TO FIT 1-3/4" DOOR, WITH A JAMB DEPTH OF 5-7/8" OR 7-1/8" ONLY. FRAME IS TEMPLATED FOR 4.5"x.180" MORTISED HINGES, AND REINFORCED FOR SURFACE CLOSER AND SURFACE BOLTS. COMPLETE DOOR AND FRAME UNITS ARE SUPPLIED WITH ACOUSTIC PERIMETER SEALS, DOOR BOTTOMS, THRESHOLD & ASTRAGAL (ON ACTIVE) OPTIONS AVAILABLE: FIRE RATINGS UP TO 1½ HOUR, AND SOME ADDITIONAL HARDWARE PREPARATIONS. (CONSULT FACTORY)

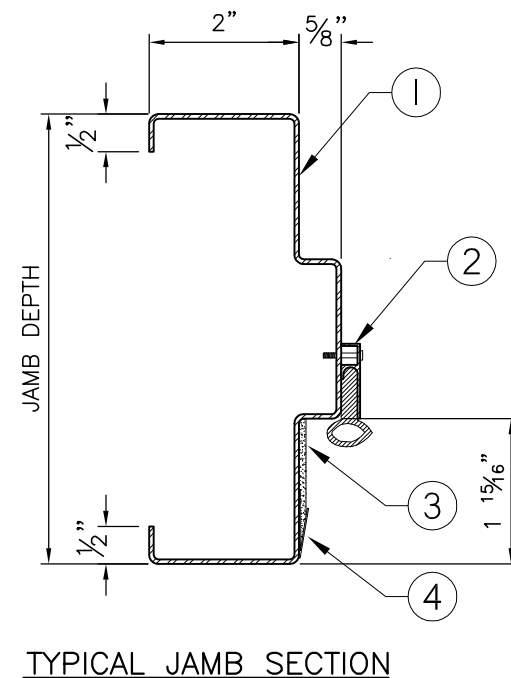
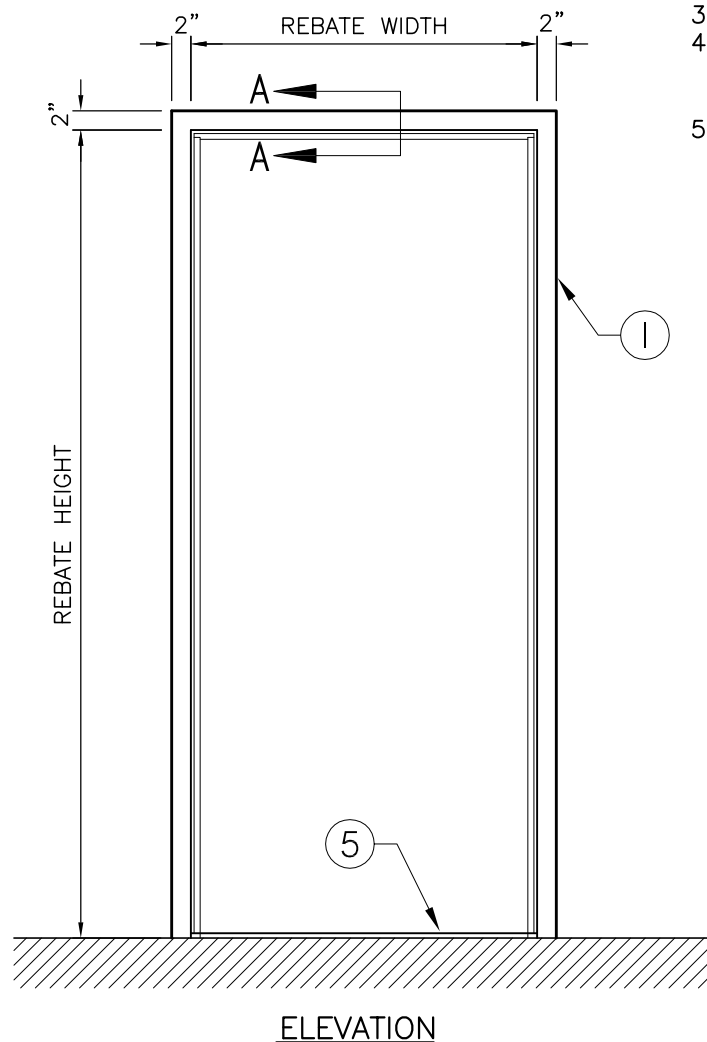

**NOTE:**  
 FRAME MUST BE INSTALLED AT FINISHED FLOOR HEIGHT.  
 (DO NOT EMBED IN FLOOR)

## TYPICAL ACOUSTIC STEEL SINGLE FRAME AND PERIMETER SEALS FOR STEEL DOORS – STC 49 TO STC 52