

ELEVATION
 $\frac{3}{4}'' = 1'-0''$

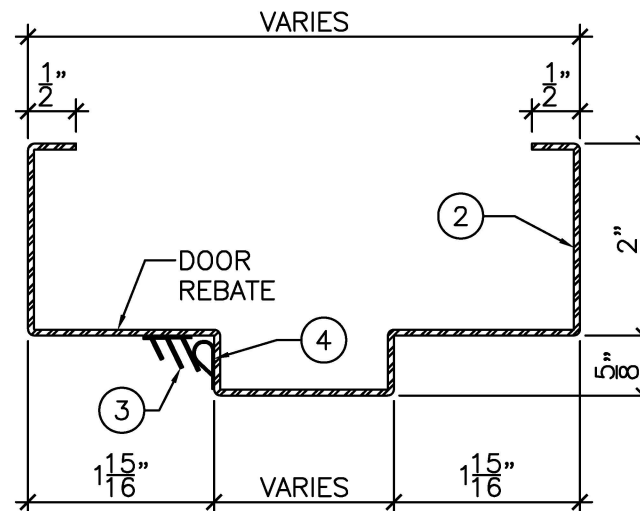

DETAIL "A"
 $6'' = 1'-0''$

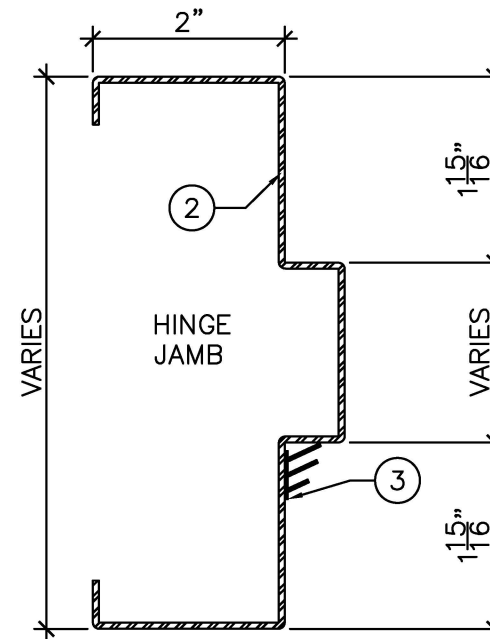

DETAIL "B"
 $6'' = 1'-0''$

LEGEND:

1. $\frac{1}{4}''$ HIGH ACOUSTIC THRESHOLD.
2. PRESSED STEEL ACOUSTIC FRAME TO BE INSTALLED AT TOP LEVEL OF FINISHED FLOOR COVERING MATERIAL.
 (DO NOT EMBED IN FLOOR FINISHING).
3. ACOUSTIC PERIMETER FIN SEAL TO BE FITTED AND FASTENED TO FRAME BY INSTALLER ON SITE.
4. ACOUSTIC PERIMETER BULB SEAL TO BE FITTED AND FASTENED TO FRAME BY INSTALLER ON SITE.

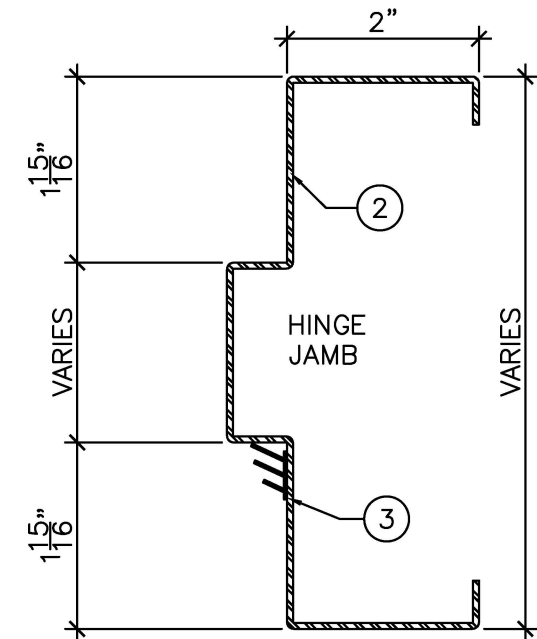

DETAIL "C"
 $6'' = 1'-0''$



DRAWING TITLE:

ACOUSTIC STEEL PAIRED FRAME AND PERIMETER SEALS FOR STEEL DOORS
STC 33 TO STC 38

DATE:	2020/07/20
DRAWN BY:	ASC
REVISION:	1