

LEGEND:

- 1. STAINLESS STEEL SPLIT FRAME TO BE INSTALLED AT TOP LEVEL OF FLOOR COVERING MATERIAL BY INSTALLER.
- 2. RF FOAM SEAL TO BE FIT AND APPLIED BY INSTALLER ON SITE.
- 3. ACOUSTIC & RF BRONZE SEAL TO BE FIT AND APPLIED BY INSTALLER ON SITE.
- 4. ACOUSTIC BULB SEAL TO BE FIT AND FASTENED BY INSTALLER AT SITE.
- 5. #10 MACHINE SCREW AND NUT PROVIDED FOR ATTACHMENT OF GROUND WIRE BY INSTALLER ON SITE.
- 6. ANCHOR SCREW.

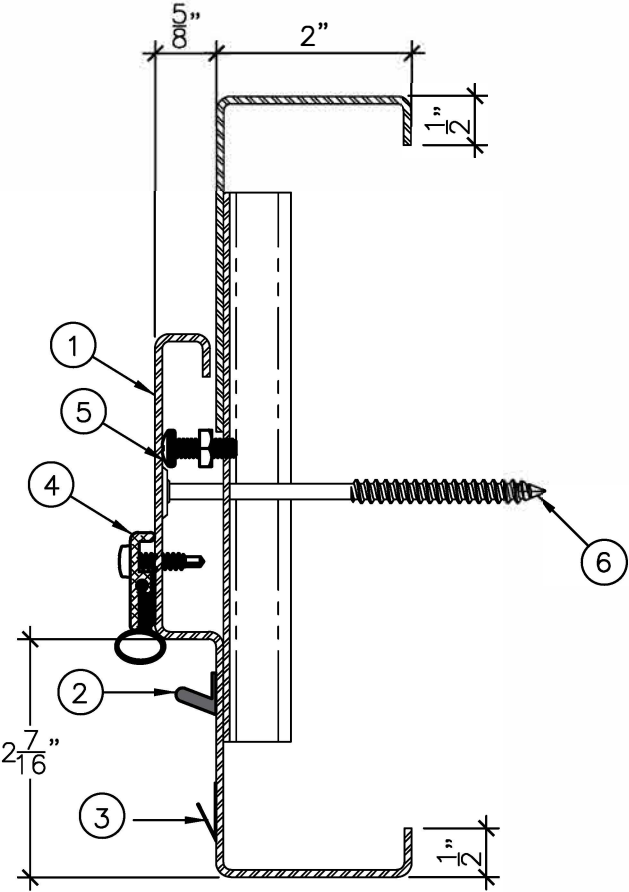

JAMB SECTION

6" = 1'-0"

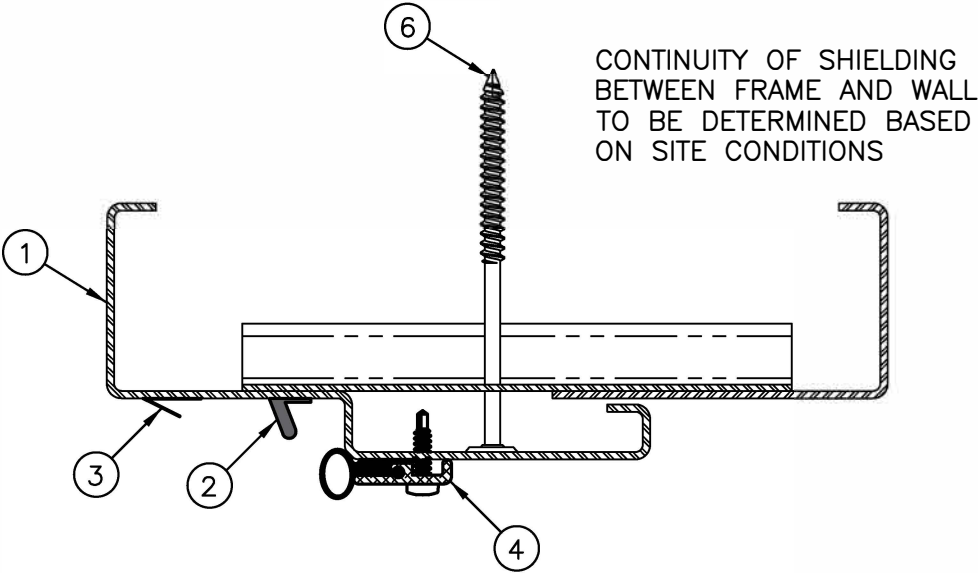

HEADER SECTION

6" = 1'-0"

NOTES:

- TO ALLOW RF SEALS INSTALLATION, DOOR RABBET CANNOT BE PAINTED OR PRIMED.
- ROUGH OPENING WIDTH = REBATE WIDTH + 2"
- ROUGH OPENING HEIGHT = REBATE HEIGHT + 1" + FINISHED FLOOR MATERIAL THICKNESS



DRAWING TITLE:

STC50-STC 53 AND 60dB RF-SHIELDED SPLIT FRAME FOR NON-FIRE STEEL AND WOOD DOORS

DATE: 2025/04/08

DRAWN BY: AA

REVISION: 0