

**ELEVATION**

3/4" = 1'-0"

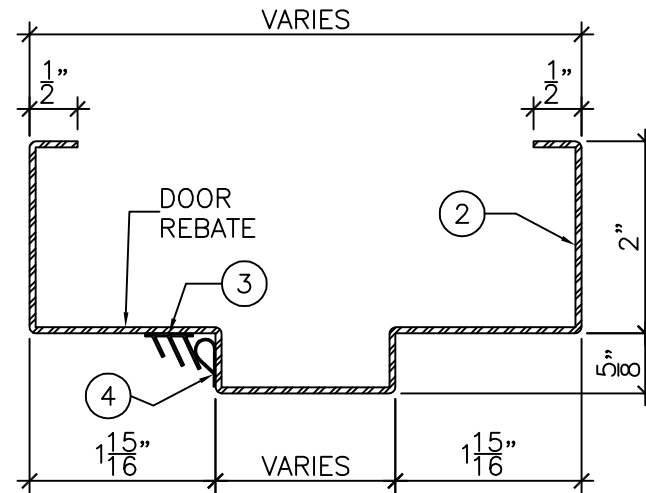

**DETAIL "A"**

6" = 1'-0"

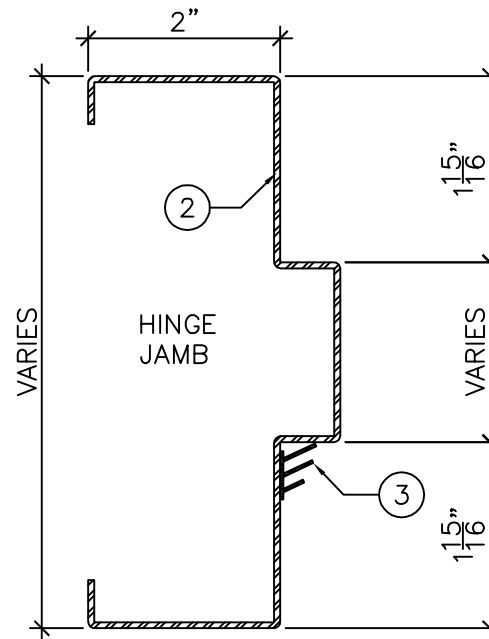

**DETAIL "B"**

6" = 1'-0"

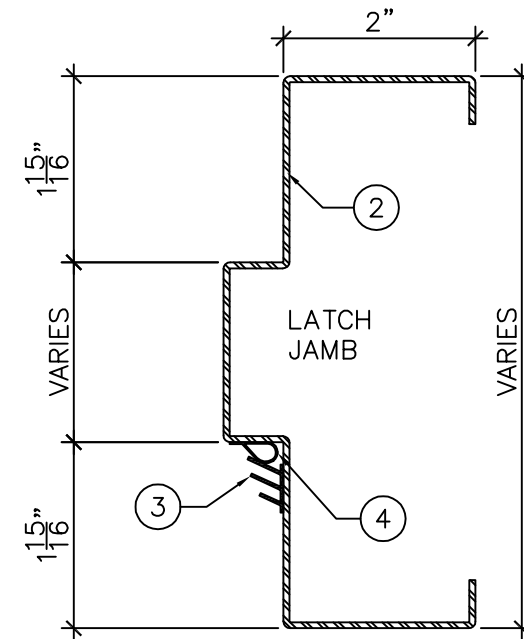

**DETAIL "C"**

6" = 1'-0"

**LEGEND:**

1. 1/2" HIGH STEPPED ACOUSTIC THRESHOLD.
2. PRESSED STEEL ACOUSTIC FRAME TO BE INSTALLED AT TOP LEVEL OF FINISHED FLOOR COVERING MATERIAL.  
(DO NOT EMBED IN FLOOR FINISHING).
3. ACOUSTIC PERIMETER SEAL TO BE FITTED AND FASTENED TO FRAME BY INSTALLER ON SITE.
4. ACOUSTIC PERIMETER BULB SEAL TO BE FITTED AND FASTENED TO FRAME BY INSTALLER ON SITE.



DRAWING TITLE:

**ACOUSTIC STEEL SINGLE FRAME AND PERIMETER SEALS FOR FIRE RATED WOOD DOORS  
STC 33 TO STC 35**

DATE:

DRAWN BY:

REVISION:

0